

This fixed-focus lens is designed for use with Panasonic's applicable projectors.
This lens is an ultra-short focal length lens which uses a mirror.

NOTE: The lens cannot be used by itself. It must be mounted onto the specified Panasonic DLP™ projector.

Specifications

F value:	2.0
Focal distance (f):	5.3 mm
Throw ratio	WUXGA 0.38:1 for PT-RZ970/RZ770/RZ660/DZ870/DZ780 (16:10 aspect ratio) WXGA 0.40:1 for PT-RW930/RW730/RW620/DW830/DW750 (16:10 aspect ratio) XGA 0.39:1 for PT-RX110/DX100/DX820 (4:3 aspect ratio)
Dimensions (W × H × D):	132 × 102 × 311 mm (5-3/16 × 4-1/32 × 12-1/4 inches)
Weight:	Approx 1.3 kg (3.1 lbs)
Applicable projector:	[Group A] PT-DZ870K/DZ870LK/DZ870W/DZ870LW/DW830K/DW830LK/DW830W/DW830LW/ DX100K/DX100LK/DX100W/DX100LW [Group B] PT-DZ770K/DZ770LK/DZ770S/DZ770LS/DW740S/DW740LS/DW740K/DW740LK/ DW730S/DW730LS/DW730K/DW730LK/DX810S/DX810LS/DX810K/DX810LK/ DX800S/DX800LS/DX800K/DX800LK/DZ680K/DZ680LK/DZ680S/DZ680LS/ DW640K/DW640LK/DW640S/DW640LS/DX610K/DX610LK/DX610S/DX610LS/ DZ6710/DZ6710L/DZ6700/ DZ6700L/DW6300S/DW6300LS/DW6300K/ DW6300LK/D6000S/D6000LS/D6000K/D6000LK/D5000S/D5000LS [Group C] PT-RZ970B/RZ970W/RZ970LB/RZ970LW/RW930B/RW930W/RW930LB/RW930LW/ RX110B/RX110W/RX110LB/RX110LW/RZ770B/RZ770W/RZ770LB/RZ770LW/ RW730B/RW730W/RW730LB/RW730LW/RZ660B/RZ660W/RZ660LB/RZ660LW/ RW620B/RW620W/RW620LB/RW620LW/RZ670B/RZ670W/RZ670LB/RZ670LW/ RW630B/RW630W/RW630LB/RW630LW [Group D] PT-DZ780/DZ780L/DW750/DW750L/DX820/DX820L

Dimensions

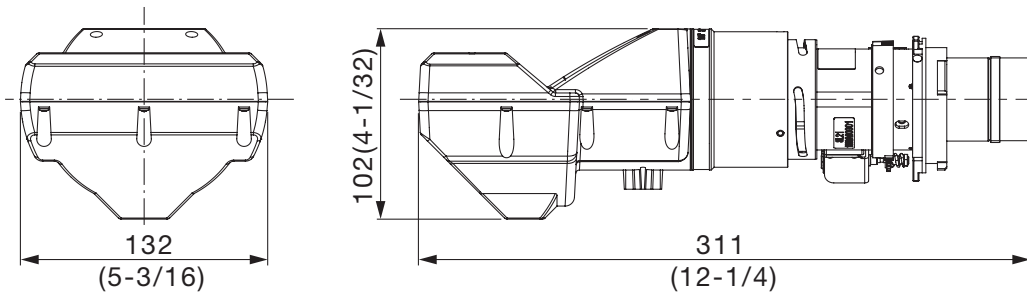
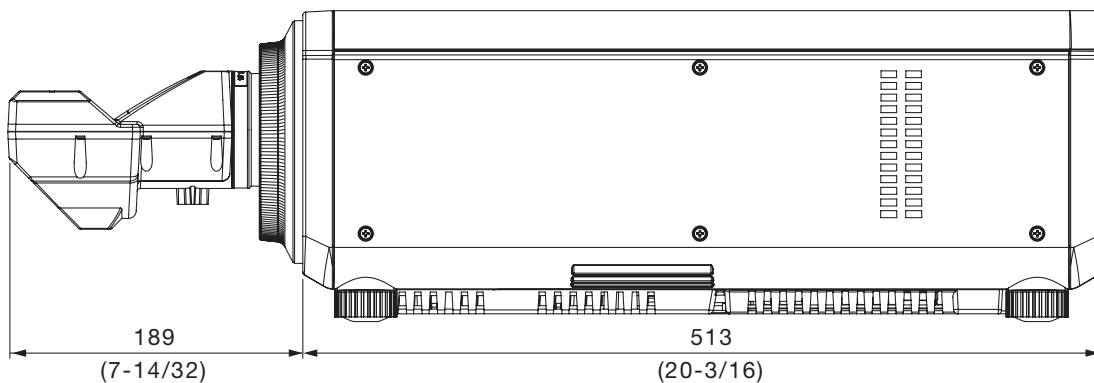

Illustration shows the lens attached to an applicable projector.

[Group A]



unit : mm (inch)

NOTE: This illustration is not drawn to scale.

[Group B]

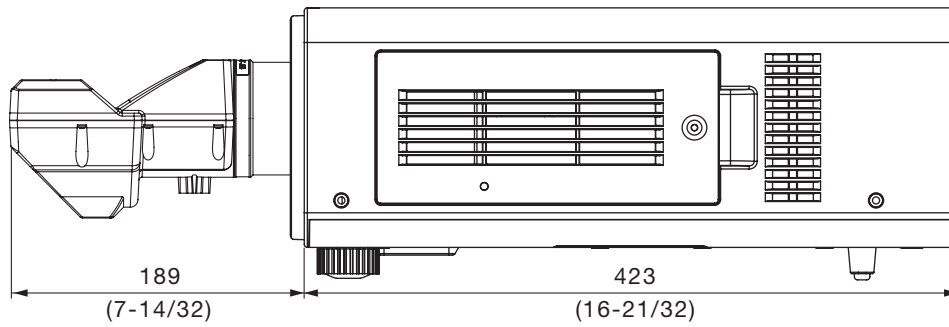

[Group C]

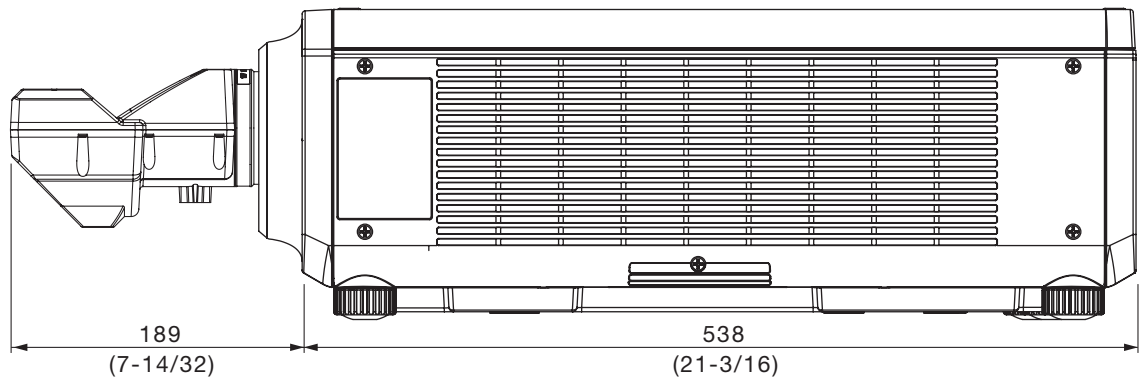

[Group D]

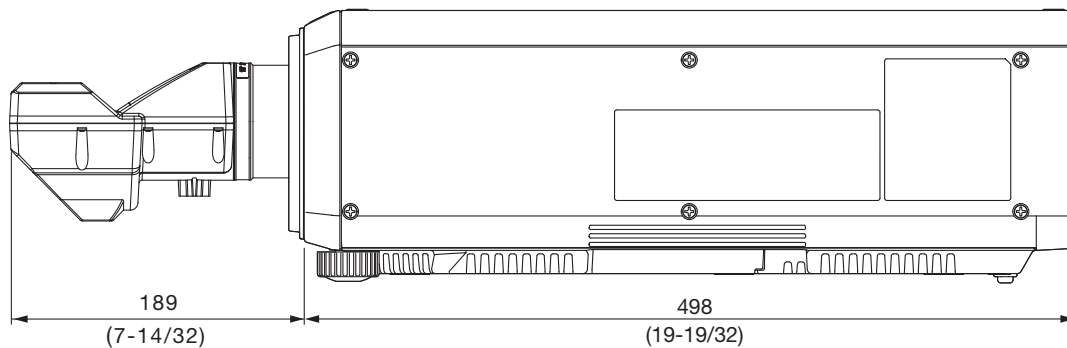

unit : mm (inch)
NOTE: This illustration is not drawn to scale.

For information on the projection distance, refer to the specifications for the projector to which the lens will be mounted.
DLP is a trademark of Texas Instruments. Weights and dimensions shown are approximate. Specifications subject to change without notice.

Fixed-Focus Lens

ET-DLE030 Projection Distance Table

RZ970/RZ770/RZ660/RZ670/DZ870/DZ770/DZ680/DZ6710/DZ6700

16 : 10 (WUXGA ; 1920 × 1200)

Unit : meters

Ultra-short focal length lens ET-DLE030 Close-up system dimensions														
Throw ratio				0.38:1	(0.39:1)	From front of set to screen (L3)	From rear of set to screen (L4)			From top of set to bottom edge of screen (A1)		From bottom of set to bottom edge of screen (A2)		
Diagonal image size (Inches)	Diagonal image size (m)	Height (SH)	Width (SW)	Projection distance (From mirror reflective surface to screen) (L1)	From tip of lens to screen (L2)		RZ970	DZ870	DZ770	RZ970	DZ770	RZ970	DZ770	
						RZ770		DZ680	RZ770	DZ680	RZ660	DZ6710	RZ660	DZ6710
						RZ660		DZ6710	RZ660	DZ6710	RZ670	DZ6700	RZ670	DZ6710
						RZ670		DZ6700	DZ870	DZ6700	DZ870	DZ6700	DZ870	DZ6700
100	2.54	1.35	2.15	0.82	0.84	0.65	0.12	0.14	0.23	0.43	0.44	0.63	0.61	
120	3.05	1.62	2.59	0.98	1.00	0.82	0.28	0.30	0.39	0.53	0.54	0.73	0.71	
150	3.81	2.02	3.23	1.23	1.25	1.06	0.52	0.55	0.64	0.68	0.69	0.88	0.86	
200	5.08	2.69	4.31	1.63	1.66	1.47	0.93	0.95	1.04	0.93	0.94	1.13	1.11	
250	6.35	3.37	5.39	2.04	2.06	1.87	1.34	1.36	1.45	1.18	1.19	1.38	1.36	
300	7.62	4.04	6.46	2.45	2.47	2.28	1.74	1.77	1.86	1.43	1.44	1.63	1.61	
350	8.89	4.71	7.54	2.85	2.88	2.69	2.15	2.18	2.27	1.69	1.69	1.89	1.87	

Unit : feet

Ultra-short focal length lens ET-DLE030 Close-up system dimensions														
Throw ratio				0.38:1	(0.39:1)	From front of set to screen (L3)	From rear of set to screen (L4)			From top of set to bottom edge of screen (A1)		From bottom of set to bottom edge of screen (A2)		
Diagonal image size (Inches)	Diagonal image size (m)	Height (SH)	Width (SW)	Projection distance (From mirror reflective surface to screen) (L1)	From tip of lens to screen (L2)		RZ970	DZ870	DZ770	RZ970	DZ770	RZ970	DZ770	
						RZ770		DZ680	RZ770	DZ680	RZ660	DZ6710	RZ660	DZ6710
						RZ660		DZ6710	RZ660	DZ6710	RZ670	DZ6700	RZ670	DZ6710
						RZ670		DZ6700	DZ870	DZ6700	DZ870	DZ6700	DZ870	DZ6700
100	2.54	4.4	7.1	2.7	2.8	2.1	0.4	0.5	0.8	1.4	1.4	2.1	2.0	
120	3.05	5.3	8.5	3.2	3.3	2.7	0.9	1.0	1.3	1.7	1.8	2.4	2.3	
150	3.81	6.6	10.6	4.0	4.1	3.5	1.7	1.8	2.1	2.2	2.3	2.9	2.8	
200	5.08	8.8	14.1	5.4	5.4	4.8	3.0	3.1	3.4	3.1	3.1	3.7	3.6	
250	6.35	11.0	17.7	6.7	6.8	6.1	4.4	4.5	4.8	3.9	3.9	4.5	4.5	
300	7.62	13.3	21.2	8.0	8.1	7.5	5.7	5.8	6.1	4.7	4.7	5.4	5.3	
350	8.89	15.5	24.7	9.4	9.4	8.8	7.1	7.1	7.4	5.5	5.5	6.2	6.1	

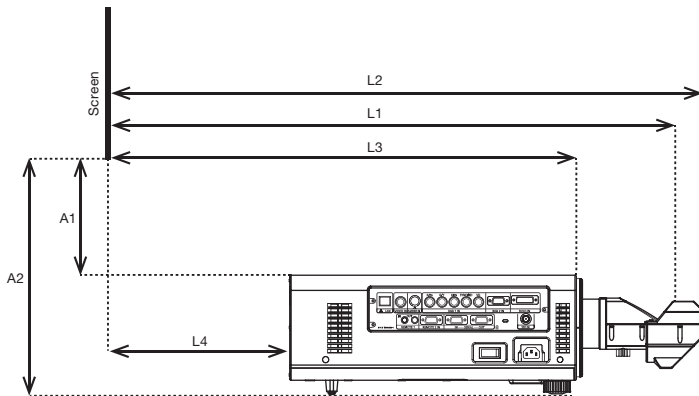

- L1: Projection distance (from screen to mirror reflective surface)
- L2: From screen to tip of lens
- L3: From screen to front of set
- L4: From screen to rear of set
- A1: From bottom edge of screen to top of set
- A2: From bottom edge of screen to bottom of set

Projection Distance Calculation Table

Screen aspect ratio 16:10

Projection distance calculation formula

$$L1 \text{ (m)} = 0.3205 \times \text{Diagonal image size} + 0.00467$$

Calculation formula for distance from top of set to bottom edge of screen

RZ970/RZ770/RZ660/RZ670/DZ870	A1 (m) = 0.1977 x Diagonal image size - 0.07210
DZ770/DZ680/DZ6710/DZ6700	A1 (m) = 0.1977 x Diagonal image size - 0.06710

RW930/RW730/RW620/RW630/DW830/DW740/DW730/DW640/DW6300

16 : 10 (WXGA ; 1280 × 800)

Unit : meters

Ultra-short focal length lens ET-DLE030
Close-up system dimensions

Diagonal image size (Inches)	Diagonal image size (m)	Throw ratio		Projection distance (From mirror reflective surface to screen) (L1)	From tip of lens to screen (L2)	From front of set to screen (L3)	From rear of set to screen (L4)			From top of set to bottom edge of screen (A1)		From bottom of set to bottom edge of screen (A2)		
		0.40:1	(0.41:1)				RW930	DW830	DW740	RW930	DW740	RW930	DW740	RW730
							RW730		DW730	RW620	DX640	RW630	DW830	DW6300
100	2.54	1.35	2.15	0.86	0.88	0.69	0.16	0.18	0.27	0.59	0.59	0.79	0.77	
120	3.05	1.62	2.59	1.03	1.05	0.86	0.33	0.35	0.44	0.72	0.72	0.92	0.90	
150	3.81	2.02	3.23	1.29	1.31	1.12	0.58	0.61	0.70	0.92	0.92	1.12	1.10	
200	5.08	2.69	4.31	1.71	1.74	1.55	1.01	1.04	1.13	1.25	1.25	1.45	1.43	
250	6.35	3.37	5.39	2.14	2.16	1.98	1.44	1.46	1.55	1.58	1.58	1.78	1.76	
300	7.62	4.04	6.46	2.57	2.59	2.40	1.86	1.89	1.98	1.91	1.91	2.11	2.09	
350	8.89	4.71	7.54	3.00	3.02	2.83	2.29	2.32	2.41	2.24	2.24	2.44	2.42	

Unit : feet

Ultra-short focal length lens ET-DLE030
Close-up system dimensions

Diagonal image size (Inches)	Diagonal image size (m)	Throw ratio		Projection distance (From mirror reflective surface to screen) (L1)	From tip of lens to screen (L2)	From front of set to screen (L3)	From rear of set to screen (L4)			From top of set to bottom edge of screen (A1)		From bottom of set to bottom edge of screen (A2)		
		0.40:1	(0.41:1)				RW930	DW830	DW740	RW930	DW740	RW930	DW740	RW730
							RW730		DW730	RW620	DX640	RW630	DW830	DW6300
100	2.54	4.4	7.1	2.8	2.9	2.3	0.5	0.6	0.9	1.9	1.9	2.6	2.5	
120	3.05	5.3	8.5	3.4	3.5	2.8	1.1	1.2	1.4	2.4	2.4	3.0	2.9	
150	3.81	6.6	10.6	4.2	4.3	3.7	1.9	2.0	2.3	3.0	3.0	3.7	3.6	
200	5.08	8.8	14.1	5.6	5.7	5.1	3.3	3.4	3.7	4.1	4.1	4.7	4.7	
250	6.35	11.0	17.7	7.0	7.1	6.5	4.7	4.8	5.1	5.2	5.2	5.8	5.8	
300	7.62	13.3	21.2	8.4	8.5	7.9	6.1	6.2	6.5	6.3	6.3	6.9	6.8	
350	8.89	15.5	24.7	9.8	9.9	9.3	7.5	7.6	7.9	7.3	7.3	8.0	7.9	

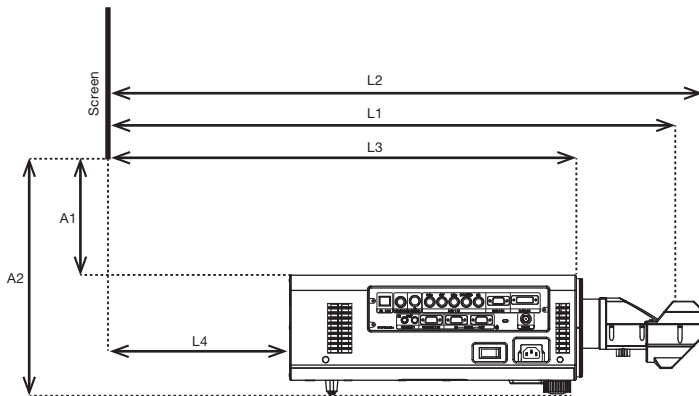

- L1: Projection distance (from screen to mirror reflective surface)
- L2: From screen to tip of lens
- L3: From screen to front of set
- L4: From screen to rear of set
- A1: From bottom edge of screen to top of set
- A2: From bottom edge of screen to bottom of set

Projection Distance Calculation Table

Screen aspect ratio 16:10

Projection distance calculation formula

$$L1 \text{ (m)} = 0.3365 \times \text{Diagonal image size} + 0.00467$$

Calculation formula for distance from top of set to bottom edge of screen

RW930/RW730/RW620/RW630/DW830	A1 (m) = 0.2597 × Diagonal image size - 0.07396
DW740/DW730/DW640/DW6300	A1 (m) = 0.2597 × Diagonal image size - 0.06896

RX110/DX100/DX810/DX800/DX610/D6000/D5000

4 : 3 (XGA ; 1024 x 768)

Unit : meters

Ultra-short focal length lens ET-DLE030
Close-up system dimensions

Throw ratio				0.39:1	(0.41:1)	From front of set to screen (L3)	From rear of set to screen (L4)		From top of set to bottom edge of screen (A1)		From bottom of set to bottom edge of screen (A2)	
Diagonal image size (Inches)	Diagonal image size (m)	Height (SH)	Width (SW)	Projection distance (From mirror reflective surface to screen) (L1)	From tip of lens to screen (L2)		RX110 DX100	DX810/DX800 DX610/D6000 D5000	RX110 DX100	DX810/DX800 DX610/D6000 D5000	RX110 DX100	DX810/DX800 DX610/D6000 D5000
100	2.54	1.52	2.03	0.80	0.82		0.63	0.12	0.21	0.41	0.41	0.61
120	3.05	1.83	2.44	0.96	0.98	0.79	0.28	0.37	0.50	0.51	0.70	0.68
150	3.81	2.29	3.05	1.20	1.22	1.03	0.52	0.61	0.65	0.65	0.85	0.83
200	5.08	3.05	4.06	1.60	1.62	1.43	0.92	1.01	0.88	0.89	1.08	1.06
250	6.35	3.81	5.08	1.99	2.02	1.83	1.32	1.41	1.12	1.13	1.32	1.30
300	7.62	4.57	6.10	2.39	2.42	2.23	1.71	1.80	1.36	1.37	1.56	1.54
350	8.89	5.33	7.11	2.79	2.81	2.62	2.11	2.20	1.60	1.61	1.80	1.78

Unit : feet

Ultra-short focal length lens ET-DLE030
Close-up system dimensions

Throw ratio				0.39:1	(0.41:1)	From front of set to screen (L3)	From rear of set to screen (L4)		From top of set to bottom edge of screen (A1)		From bottom of set to bottom edge of screen (A2)	
Diagonal image size (Inches)	Diagonal image size (m)	Height (SH)	Width (SW)	Projection distance (From mirror reflective surface to screen) (L1)	From tip of lens to screen (L2)		RX110 DX100	DX810/DX800 DX610/D6000 D5000	RX110 DX100	DX810/DX800 DX610/D6000 D5000	RX110 DX100	DX810/DX800 DX610/D6000 D5000
100	2.54	5.0	6.7	2.6	2.7		2.1	0.4	0.7	1.3	1.3	2.0
120	3.05	6.0	8.0	3.1	3.2	2.6	0.9	1.2	1.6	1.7	2.3	2.2
150	3.81	7.5	10.0	3.9	4.0	3.4	1.7	2.0	2.1	2.1	2.8	2.7
200	5.08	10.0	13.3	5.2	5.3	4.7	3.0	3.3	2.9	2.9	3.6	3.5
250	6.35	12.5	16.7	6.5	6.6	6.0	4.3	4.6	3.7	3.7	4.3	4.3
300	7.62	15.0	20.0	7.8	7.9	7.3	5.6	5.9	4.5	4.5	5.1	5.1
350	8.89	17.5	23.3	9.2	9.2	8.6	6.9	7.2	5.3	5.3	5.9	5.8

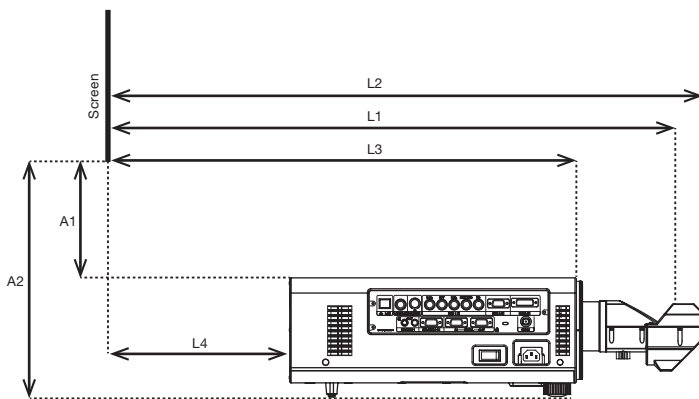

- L1: Projection distance (from screen to mirror reflective surface)
- L2: From screen to tip of lens
- L3: From screen to front of set
- L4: From screen to rear of set
- A1: From bottom edge of screen to top of set
- A2: From bottom edge of screen to bottom of set

Projection Distance Calculation Table

Screen aspect ratio 4:3

Projection distance calculation formula

$$L1 (m) = 0.3133 \times \text{Diagonal image size} + 0.00467$$

Calculation formula for distance from top of set to bottom edge of screen

RX110/DX100	A1 (m) = 0.1881 x Diagonal image size - 0.07149
DX810/DX800/DX610/D6000/D5000	A1 (m) = 0.1881 x Diagonal image size - 0.06649